

- DATA APPLICATIONS ONLY.
- MINIMAL USE OF PC BOARD AREA (<1.0"/25.4mm SQUARE).
- LOW PROFILE (<.525"/13.34mm)
- DESIGNED FOR "WET" (W/ DC) CIRCUITS.
- IMPEDANCE RATIOS OF 600 ct Ω : 600 ct Ω .
- UL RECOGNIZED COMPONENT - UL 1863, FILE E138250.

| REVISIONS | | | |
|-----------|-----|---|--------|
| DATE | REV | DESCRIPTION | APPV'D |
| 2-13-96 | -1 | Chg'd .500" ref. to Max | TJK |
| 01-09-02 | -2 | Changed dimension from .500" max to .510" max | G.G. |
| 04-08-16 | -3 | Updated entire drawing, added millimeters | TJK |

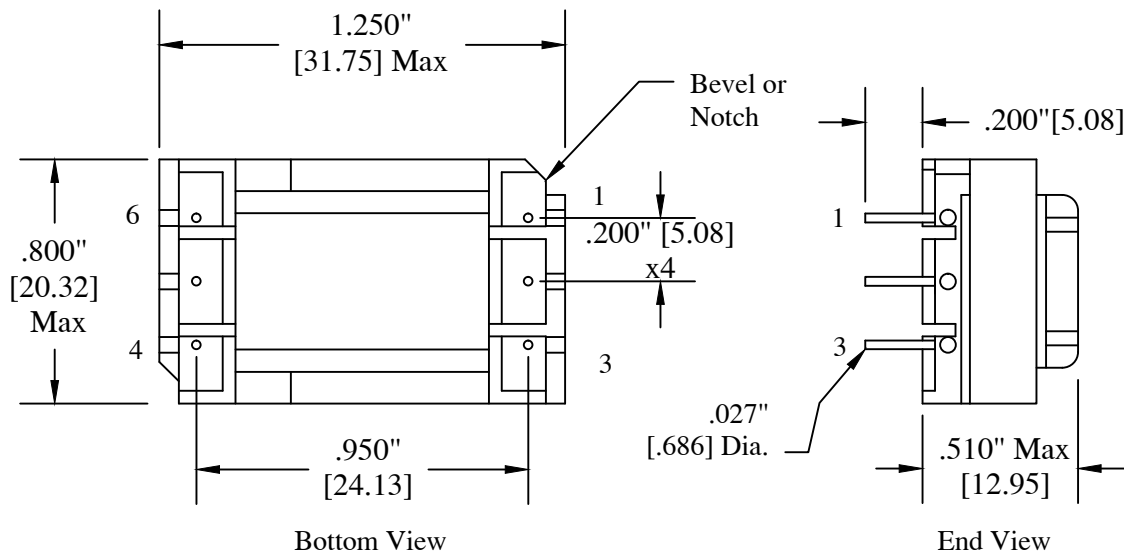

Note: All dimensions are reference unless otherwise specified.

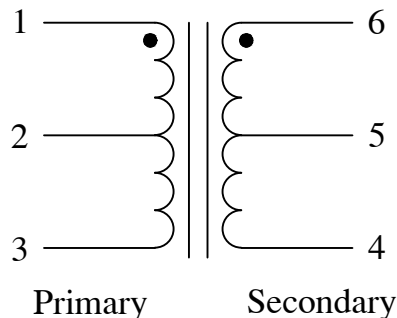

Electrical Parameters

Primary Impedance : 600 ct Ω

Secondary Impedance : 600 ct Ω

DC Unbalance : 90mA Max

Turns Ratio: 1:1.04 \pm 2%

(The following transmission tests are conducted with 90 mA D.C. and a secondary load of 600 Ω)

Frequency Response : 500-3500 \pm 1.3dB
300-3500 \pm 2.5dB

Insertion Loss (@1.8KHz) : 1.7dB Ref.

Return Loss @ 1800Hz : 14.0dB Min.

T.H.D. 0dBm @300Hz : -50dB Typical

Longitudinal Balance : 60 dB Min per IEEE #455-1985

DCR Primary : 75 Ω \pm 10%

Secondary : 100 Ω \pm 10%

Dielectric Strength : 1500 Vrms Instant P-S-C

| | | | |
|--|-----------------|--|--|
| PREM MAGNETICS INCORPORATED | | CUSTOM ENGINEERING MAGNETIC COMPONENTS Johnsburg, Illinois 3521 N. Chapel Hill Rd. / McHenry, Illinois 60051 | |
| SCALE: None | APPROVED BY: | DRAWN BY Tjk | |
| DATE: 04/08/16 | <i>Tj Klotz</i> | REVISED | |
| Standard Product Transformer p/n SPT-2108 | | | |
| | | DRAWING NUMBER | |
| | | C-SPT-2108 -3 | |